

Practical

START TOURING TODAY!
20 top tips for holiday heaven



Summer Special 2017

Motorhome

GET SET FOR SUMMER!

GREAT LAKES

Snowdonia stars in our Great British Lake-Off!

PLUS!
CORNWALL
8 TOP SITES
RATED



Mobilvetta K-Yacht:
A-class flair from Italy!
Full live-in test, p70

Glanlyn Lakeside Caravan
& Camping Park, Wales

TESTED

Adria Coral 690 SC
SsangYong Turismo

BUYING USED

VW California shootout



NEW GEAR SPECIAL

Must-have kit for summer touring

A 'VAN IS BORN

We go behind the scenes at Auto-Trail

haymarket



28 >
£4.20

MOBILVETTA

K-Yacht Tekno Line MH-85

New to the UK for 2017, this stylish Italian-built A-class range is priced within the reach of many discerning buyers. But just how tempting is it?

WHERE WE STAYED

Billing Aquadrome, Crow Lane, Great Billing, Northampton NN3 9DA
Tel 01604 408 181
Web www.billingaquadrome.com
 A huge 235-acre resort – for holiday homes as well as motorhomes and caravans – that comes complete with a leisure centre, a fishing lake, and much else designed to amuse the family

- **Price** From £67,995 OTR (£69,745 as tested) • **Sleeps** 4 • **Belts** 4 • **Base vehicle** Fiat Ducato
- **Engine** 2.3-litre turbodiesel, 150hp, Euro 6 • **L/W/H** 7.38/2.35/2.89m (24'3"/7'9"/9'5")
- **MTPLM** 3500kg • **Payload** 342kg • **Water** (fresh/waste) 120/110 litres • **Battery** 110Ah • **Gas** 2 x 6kg

Mobilvetta may sound and look Italian but, *mamma mia*, as with so much else in the motorhome industry these days, it is actually part of a much larger multi-national concern – in this case, French-owned Trigano.

Despite such support, it had been largely absent from these shores for most of the past decade, a result of the late-2000s financial crisis that saw the Italian motorhome market contract by as much as one fifth. That was up until the start of this season, though, when Marquis Leisure, keen to add an A-class brand to its portfolio, brought Mobilvetta back to British forecourts (Marquis is enjoying no little success with Benimar, itself another Trigano brand).

So far potential UK buyers have only seen three models from the brand's K-Yacht Tekno Line, which, surprise surprise, has been designed to incorporate elements of nautical style. Earlier this season, we tested the K-Yacht MH-80, which carries an innovative rear lounge layout. Now we're taking the K-Yacht MH-85, with single beds in the back and a drop-down over the dinette, for a spin through rural Northamptonshire.

DESIGN

★★★★★

Rocking a monochrome exterior, the K Yacht looks very Italian. With its dipped-down, pointed nose you can begin to see the resemblance to a luxury yacht, too. It looks sleek on the move – especially with its 16in alloy wheels. Yet this is a motorhome that still manages to include a double

floor, with two external lockers fitted into it to complement the garage at the rear. Doors to all such spaces have solid catches to keep them secure.

The yacht theme is even more apparent in the interior, with a large amount of shiny wood veneer, lots of mirrors to exaggerate space, just as you might get inside a yacht, a pearly white

tambour door on the washroom, a pearl finish to the lockers with just one silver strip, and chrome retainers on some of the shelves that look like they could be the place for a sailing trophy. All in all, it's a masculine look.

Except, possibly, for the LED lighting. There's a great amount of it in here, mostly in the form of strips that are designed to highlight key design elements like the partition back to the travel seats. Fortunately these strips are all in white LED light, not the blue that was initially popular, and which we think tended to make motorhome interiors look like somewhere you might expect to see a disco ball. The only blue lights here are little nightlights which some might find annoying.



ON THE ROAD

★★★★★

The one-rung-up-from-standard 150bhp Fiat Ducato engine helped the 'van cope with some fairly muddy fields that we encountered. Overall the Mobilvetta offers a smooth ride, partly due to the Comfort-Matic gearbox our test model had as a £1750 cost option, and thanks to the Drivers Pack which comes as standard on UK models. This includes cruise

WHAT MOTORHOME? Four-berth A-class



WATCHING ALL BEHIND

The rear-view camera included on this specced-up motorhome is a useful bonus, and is discreetly hidden in the rear moulding



ROOM UNDERNEATH

The double floor means you get two external lockers capable of storing bulky goods – and they come with sensible solid catches



THE BIKE FITS IN TOO

The garage at the back is well lit and easily tall enough to fit cycles in an upright position. The netted pockets are useful, too



QUITE A BUSY DASH

With a top-mounted reversing camera and those metallic brown infills, the dashboard isn't the neatest one we've ever seen



FULLY SOCIABLE

The L-shaped kitchen and dinette means no one need feel isolated when they're putting a meal together. There's plenty of room to move around here, too



SUCKING IT ALL AWAY

The extractor fan included in this spacious kitchen is a definite plus, as is the splashguard next to the three-burner hob



NOT FORGETTING A BIN

There's even a small waste bin included in the kitchen worktop, complete with a well-fitting lid to make it as inconspicuous as possible



KEEPING IN CONTROL

Controls for the lights, the heating and the water pump are easy to access on this smart touchscreen panel above the habitation door



MORE AND MORE ROOM

A clever storage system telescopes out beneath the kitchen worktop to provide a huge amount of storage space for all your essentials

⊕ LIVE-IN TEST



LADDER UP TOP

The MH-85's fixed twin-single beds can be made into a spacious double by adding a mattress infill and attaching a wooden ladder



WARDROBE FUNCTIONS

There's a large, easily accessible wardrobe underneath the foot of each bed, while shelves make use of space in the curved door



SPACE IN THE STEPS

Cubbyholes inside the steps between the beds are another example of how good use is made of the MH-85's internal space

A QUESTION OF HEIGHT

Once you climb into the beds, there isn't masses of headroom available but the mattresses can be raised at the pillow end for reading



control, ESP, Traction Plus, hill assist, hill descent, and driver and passenger airbags. The 'van did tend to rattle quite a bit inside, however.

As is usual with A-classes, it was quite a squeeze to get your hand down between the driver's seat and the back of the gas bottle locker to pull on the handbrake – although this situation wasn't as bad as it is on some A-classes we have driven. The A-pillar on the driver's side window occasionally caused a blind spot, but again we have seen worse.

More noticeable was the tendency the passenger side door had to knock the coach-style drop-down side mirror if you don't pay full attention when opening it. This applied no matter what position you put the mirror in. The rear-view camera is very useful on a 'van of this length. It pops up from the centre of the dashboard, but does mean you lose out on having the Ducato's handy tablet holder (it's a shame the designers have opted for Fiat's brown dash infills, as they jar slightly with the habitation's wood finish).

There are two travel seats behind, and they must be decent because one of our party fell asleep in one of them while in transit. To use the one nearest the window you have to remove part of the L-shaped seat, but there was enough legroom here after we had done so to accommodate an adult of average height.

LOUNGING AND DINING



A front dinette is usually going to be a space challenge in a motorhome with fixed beds. Here it is less so because the designers have found enough space to incorporate an L-shaped seat and a small side seat to the right of the habitation door.

But even if our team-mate did fall asleep on the move, these seats are really only moderately comfy when the



SPRUCE UP NICELY

You really begin to see the nautical influences on the K-Yacht's design here in the washroom, with its silver basin and wood finish



SHOWER SENSATION

There's a high spec level in the shower cubicle too, with a modern shower head, racks for storage, and a hanging rail for wet clothes



MIRRORS TO ADMIRE

Along with proving useful for getting yourself ready, the well-lit mirrors in the washroom enhance the overall sense of space



motorhome is stationary. The main bench in particular seems very upright.

You would probably be more inclined, as we were, to use the swivelled cab seats if it is just the two of you. They would certainly give you a prime position for watching the TV if you were to install one on the bracket fitted to the left of the habitation door.

The table is fully adjustable, but we found it was always a little far out from the side seat, which, like the bench, is not super-comfortable.

The seat is, however, a useful place for putting on any shoes you might keep in the nearby cubbyhole in the double floor.

The lounge is adequately heated with one vent to the side and another by the door. There is one mains socket in this area, which is a bit of a squeeze to get to as it is under the L-shaped seat, but the sockets in the kitchen are nearby.

A rooflight keeps this area bright and airy, even taking the drop-down bed into account, and alongside those LED striplights there are plenty of LED spotlights, including four in a row by the drop-down bed's curtain, plus two by the door that come on automatically as you enter the motorhome. The drop-down bed has speakers in the base, too.

KITCHEN



The cooking area in the MH-85 is one of the best we have seen in recent times. There is only a three-burner hob, but it is cleverly tucked into the corner, and there is a large sink with a cover that alternates as a chopping board and fits into a slot on a rail that runs along the top of the partition by the sink. That's a useful idea, although we would be tempted to swap the board's position with the paper towel holder that also sits on this rail so that the board is directly over the bin

“The cooking area in the MH-85 is one of the best that we have seen in recent times”

behind the sink, and all food waste can simply be scraped off and dropped in.

The whole work surface is well lit, with a 12V and mains socket next to the light switch, and there's even an extractor fan.

There's another potential resting place for the chopping board on top of the cutlery tray under the worktop. Here, it can form an extension flap.

Two large drawers and an ingenious shelving system that telescopes out next to them means that there is plenty of room for even quite large pans and utensils. Up above, the two overhead lockers are also large.

Having so much space to hand makes you wonder why the designers bothered with the tiny apothecary shelf across the aisle. Next to it is a three-way 150-litre Thetford fridge, and a SMEV oven and grill above that – it will be a little high for some, though.

WASHROOM



The washing area is split across the middle of the 'van. A stylish-looking stainless steel basin with a soap dispenser and mug embedded into the worktop around it and two differently angled mirrors behind it takes up one side, along with a swivel toilet with toilet roll holder and brush. There's also one overhead locker and a cupboard under the basin that is partly obscured by a thin towel rail.

This area, which is partitioned off by a tambour door, also has a window and a roof vent with a fan. Strangely, you won't find the latter in the shower

LAYOUT



WASTE WATER	FRESH WATER	BATTERY	GAS
110 litres	120 litres	110Ah	2 x 6kg

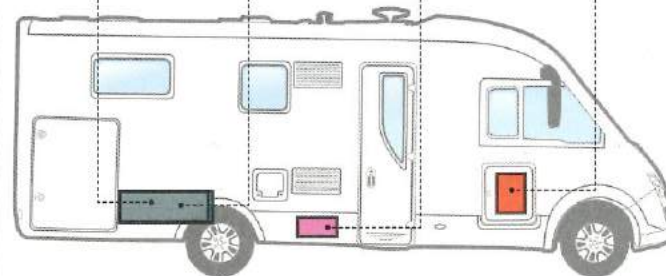

Rear singles: 2.03 x 0.83m (6'8" x 2'9")	Drop-down double: 1.88 x 1.33m (6'2" x 4'4")
--	--

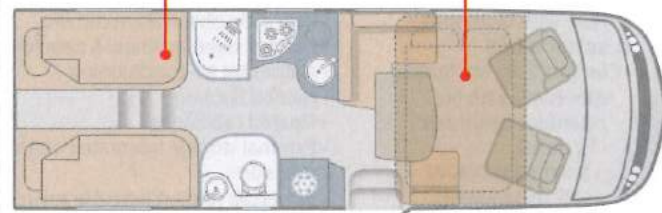

THE MOBILVETTA STORY

Mobilvetta is relatively unusual among motorcaravan manufacturers in



having started life in the 1960s as a furniture company, rather than a motorhome producer. It was taken over by Trigano (which also started life outside the world of motorhomes) in 2012, when the French company took over the struggling SEA Group, which by then had acquired Mobilvetta. As well as Mobilvetta, SEA's other brands also included Elnagh and McLouis, and it had previously owned Auto-Sleepers, which Trigano bought outright earlier this year, along with Marquis Leisure. Mobilvetta is based in Poggibonsi in Tuscany, a much-loved part of Italy that is also something of a centre for motorhome manufacturing – upmarket brand Laika, part of the Erwin Hymer Group, is also located there



cubicle across the aisle, which also only has one drain hole – a sign, perhaps, that this is an affordable A-class. But the shower head itself looks ultra-modern, and there are solid metal shelves for stowing all your lotions and potions.

The whole washroom area can be partitioned off from the front lounge and kitchen by means of an elegant Japanese-style door.

SLEEPING



The comfortable fixed beds at the rear are reached by steps. The beds are reasonably high, which means you don't have a huge amount of headroom. But as the mattresses themselves can be raised at the pillow end, support is available for sitting up in bed.

Sleepers get spotlights for reading, while in the middle between the two beds is a very large wooden shelf that could easily serve as a resting place for books.

If you would rather cuddle up for the night, you can pull out an extension over the steps and insert a couple of infills to create a double.

The drop-down bed over the cab was a little more complicated to position than we had expected. The folded cab seats need to rest an inch or so before their forward-most position, not right at the end. Trying to work this out inevitably involved accidentally sounding the horn, so you might need to be careful if you are putting this bed down late at night. Once it is deployed, you get a bed that is an accessible height and comes with spotlights and a rooflight.

STORAGE



You're certainly not short of space for clothes in the MH-85. Along with six overhead lockers in the bedroom, there are two huge wardrobes under the bed, one with a hanging rail and the

other with two large shelves. There are also clever sock shelves in the curve of the wardrobe doors, while two of the steps open up for storage.

The designers have made use of the double floor – not just externally with those two lockers but also internally with cubbyholes along the centre of the 'van. The one by the fridge is cleverly sub-divided to take large drinks bottles – *molto buono!*

The excellent garage, meanwhile, has two doors, a light you can remove to use as a torch, and netted storage across the back. It is big enough to take bikes upright.

The only trouble is the modest user payload of 342kg – fill up all the available storage spaces and you'll end up being overweight. Buyers with CI entitlement on their driving licences can get around this by opting for a chassis upgrade to 3650kg, which is free of charge.

EQUIPMENT



On top of the highly specified kitchen, a more powerful than average engine and a habitation wiring system that is set up to accommodate all your digital technology, one other major plus point in this van' is the underfloor heating.

It's operated chemically and is turned on via a switch by the passenger-side cab door. It's designed for comfort, rather than overall heating (you get a Truma Combi 6 system for that), but a comfortable warm floor makes for a great start to any day spent touring.

We also like what you get outside the MH-85 – an outlet for running a gas barbecue from your on-board supply, plus an external shower point for hosing things down.

If we are to niggle, being able to switch off all the habitation lights from the comfort of your bed while tucked up for the night would be a great touch. ☺

OUR TEST TEAM'S NOTES



NIALL HAMPTON
"The design of the K-Yacht is sharp and it feels well put together – you really appreciate the craft that's gone into the woodwork. There are also many thoughtful design touches, like the slide-out racking under the sink and the handy lockers in the side skirts."



CLAUDIA DOWELL
"I love the Italian styling – the rich glossy wood finish and the pale soft furnishings give it a glamorous look. One almost feels like dressing for dinner – as long as it's pasta because the high oven is not easy to reach. And my nails were saved by the lack of positive catches."



PETER BABER
"Some A-classes feel like an elephant to drive and have a huge cab, which is really a waste of space. In contrast, the Mobilvetta combines great looks on the outside with a layout that's comfortable and makes full use of the real estate. At 7.38m long it's no monster, either."

+ LIKES



A KITCHEN YOU WOULD LOVE TO HAVE AT HOME

This galley is cleverly thought out to give you a maximum amount of workspace and a workable amount of storage underneath



YOU CAN GET BIKES, AND MORE, IN HERE

The rear garage can hold your bikes, while clever storage baskets provide somewhere for you to carry accessories safely

- DISLIKES



BLINDED BY THE LIGHTS

It's great to have such a variety of lighting on board, but our testers felt it could be a bit too much, particularly if you want to turn everything off at night-time



TECHNICAL DATA



BASE VEHICLE

Chassis Fiat Ducato
Engine 2.3-litre turbodiesel, Euro 6
Power 150hp/112KW @ 3600rpm **Torque** 380Nm @ 1500rpm
Transmission 6-speed manual (optional 7-speed Comfort-Matic automatic: £1750)
Features LED daytime running lights, AM/FM radio with Bluetooth, sat-nav and USB, cab air conditioning, heated windscreen, rear view observation camera



CONVERSION

Walls and ceiling are made of a wood-free plastic resin frame and sound-absorbing materials covered in a fibreglass underbody and a non-slip abrasion-resistant PCV. Floor is also made of the same frame, with an interior and exterior fibreglass coating



LOUNGING AND DINING

Front lounge seats Five (including cab seats)
Dining Two forward facing seats, side seat and cab seats. LED lighting. Roller blinds and flyscreen to entrance door and windows



KITCHEN

Three-burner gas hob, oven/grill, extractor fan, 150-litre three-way fridge with freezer compartment, apothecary shelf, clip-on chopping board, kitchen towel holder



SLEEPING

Rear singles 2.03 x 0.83m (6'8" x 2'9")
Rear double 2.2 x 2.04m (7'3" x 6'8")
Drop-down double 1.88 x 1.33m (6'2" x 4'4")



EQUIPMENT

Truma Combi 6 dual-fuel space and water heating (iNet-ready), 12V underfloor heating, TV bracket and aerial, external barbecue point, aerial point and mains socket, Driver's Pack (cruise control, driver and passenger air bags, ESP, Traction Plus, hill assist, hill descent), Winter Pack (waste-water tank insulation and exhaust valve with anti-freeze protection)



OPTIONS FITTED

Comfort-Matic transmission (£1750)

OPTIONS AVAILABLE

Chassis upgrade to 3650kg (free of charge)

OR YOU COULD TRY...



HYMER B DL 588
From £82,440 OTR
★★★★★

Fixed singles on a sub-7m body length means you get a more cramped kitchen and washroom. You also have a price that is £10,000 more than the Mobilvetta before you add any extras. But you do get that Hymer quality...



RAPIDO 8066DF
From £67,700 OTR
★★★★★

A nigh-on identical layout and price to the Mobilvetta, with a slightly less sophisticated kitchen and with the same restricted bedroom headroom, and the same free chassis upgrade. Currently sold out in the UK

PRACTICAL MOTORHOME VERDICT



Mobilvetta is one of a handful of motorhome brands (the others being Itineo, Rapido and Pilote, at least in Essentiel spec) that offers A-class 'vans at prices close to what ordinary folk can afford. This Mobilvetta is a good £10k cheaper than Adria and Bürstner models with similar layouts, although they include Alde heating and a slightly higher specification. But there are enough innovations inside the K-Yacht MH-85, including the underfloor heating and the clever kitchen, to make this a motorhome you can really grow into, even if there are one or two niggles – like the night-lights. With Marquis Leisure's input you get a much more UK-friendly spec too, but you would be wise to opt for the free chassis upgrade.

DESIGN	★★★★★
ON THE ROAD	★★★★★
LOUNGING & DINING	★★★★★
KITCHEN	★★★★★
WASHROOM	★★★★★
SLEEPING	★★★★★
STORAGE	★★★★★
EQUIPMENT	★★★★★
OVERALL	★★★★★

New for 2017



Marquis have teamed up with the prestigious Trigano Group manufacturer Mobilvetta to bring an exciting new A-Class range to British shores.

Optional Upgrade
150bhp Comfort-Matic Gearbox
 Works in both fully automatic and sequential manual mode

79

80

85

+ Exclusive Enhancements & Key Features for 2017 across the K-Yacht Range

- NEW FIAT 150BHP EURO 6 CHASSIS AS STANDARD
- Upgrade to 3650 KG Chassis
- Optional Automatic Gear Box
- AM/FM Radio - Touch screen console with Bluetooth & sat nav & USB
- Comfort Grey Eco leather upholstery with fire retardant treatment
- TV aerial
- Solar panel 130W
- 16" alloy wheels
- External BBQ point
- External TV aerial point
- External 240v socket
- External satellite aerial point
- Storage for 2 x gas bottles
- iTech insulating technology with 100% wood free construction
- Rear view observation camera
- Leather steering wheel & gear lever
- Automatic air-conditioning
- Heated flooring
- Pleated cab blinds
- External storage integrated on the side skirts
- Swivel cab seats with double arm rests
- Electric & Heated wing mirrors
- Truma
- Combi 6 heating system with air ventilation
- Driver & passenger airbags
- Mini Heki rooflight
- Drivers Pack; ESP inc traction control plus, hill hold assist and hill descent control
- Winter Pack inc: insulated waste water tank and exhaust valve with anti-freezing prevention
- 150L three-way fridge
- Manual or electric drop down beds (selected models)
- External shower point



Drop down beds



Comfort Grey Eco leather upholstery



3-burner hob

For further information, video reviews, brochure downloads & to book a viewing visit our website:

www.marquisleisure.co.uk/k-yacht or call 0800 026 77 77



Buy a new or used motorhome or caravan from any of our 11 branches nationwide **Collect** your new or used motorhome or caravan from any of our 11 branches nationwide **Service** and Warranty Work can be carried out at any of our 11 branches nationwide **iTech 48**

Marquis Hampshire 01489 860 666 Marquis Dorset 01202 738 777 Marquis Gloucestershire 01684 296 222 Marquis Berkshire/Surrey 01635 248 888 Marquis Sussex 01825 873 377 Marquis Lancashire 01772 731 313 Marquis Devon 01752 892 977 Marquis Suffolk 01473 747 675 Marquis Northants 01604 402 888 Marquis Durham 0191 492 2480 Marquis South Yorkshire 01909 565 222

This advert does not constitute an offer by Marquis. It's the continual policy of Fiat and Mobilvetta to seek to improve their vehicles in every way and so whilst every effort has been made to ensure the details set out in this advert were correct at the time of going to press, they are unable to guarantee that no changes in specification have subsequently taken place.