



Mileo

[VIEW OUR NATIONWIDE STOCK](#)

Created for Adventure



[OVERVIEW](#)

[MILEO RANGE](#)

[FEATURES](#)

[WEIGHTS & DIMENSIONS](#)

[360° VIRTUAL TOURS](#)

[▶ VIDEO REVIEWS](#)



Created for Adventure



Mileo

Life is full of adventure; whether you are someone who travels the world seeking the thrill of unique experiences or someone who relishes in the marvels of local captivations, adventure can be found around every corner.

Our Mileo Range of motorhomes are created for adventure and travel and have been expertly designed to offer a selection of low-profile models with space-saving multi positional electric drop down beds on selected layouts.

With four models to choose from, there really is an option to suit all your lifestyle requirements.

It's amazing where you can get to with the help of a motorhome. Wherever you choose to explore, your Mileo is equipped with everything you need to make your way to your destination with ease.

 **Read The Latest Press Reviews**

"...superb continental design, British specification and excellent value for money."

Peter Vaughan, What Motorhome



OVERVIEW

MILEO RANGE

FEATURES

WEIGHTS & DIMENSIONS

 **VIRTUAL TOURS**

 **VIDEO REVIEWS**



OVERVIEW



4
MODELS

FIAT

For 2024 the Benimar Mileo range is available on a manual 140bhp engine with 3650kg chassis or a 180bhp automatic engine with a 4400kg chassis offering an exceptional payload for all your travelling essentials.



GPS Trackstar Tracker with Free One Year Subscription.

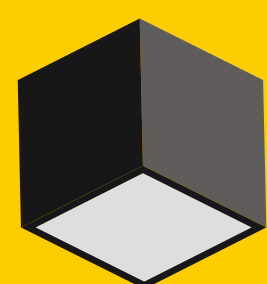

99% Wood-Free Construction.

VIEW OUR NATIONWIDE STOCK

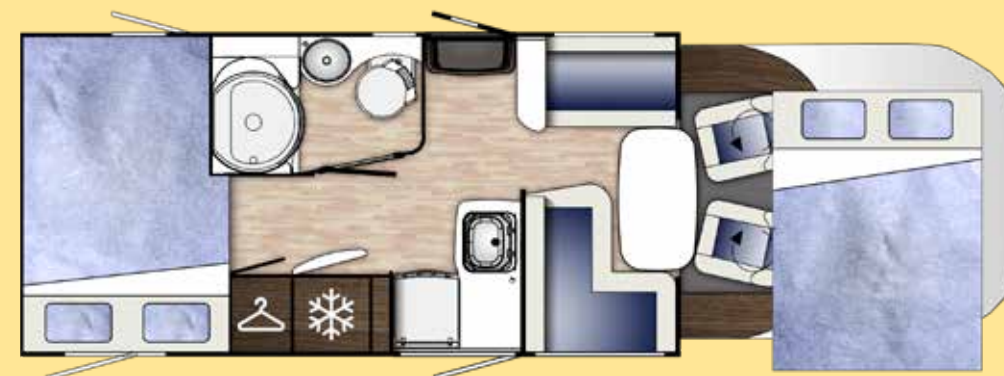

Mileo 243



OVERALL LENGTH	6990mm/22'11"	
OVERALL WIDTH (MIRRORS FOLDED)	2300mm/7'6"	
OVERALL HEIGHT (EXC AERIAL)	2890mm/9'5"	
MTPLM	3650kg	4400kg
MAX USER PAYLOAD	501kg (Manual)	1251kg (Auto)

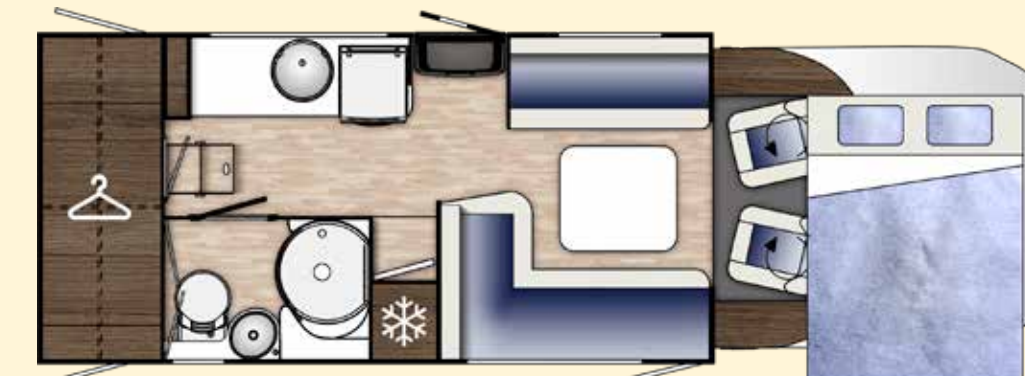

Mileo 286



OVERALL LENGTH	6950mm/22'8"	
OVERALL WIDTH (MIRRORS FOLDED)	2300mm/7'6"	
OVERALL HEIGHT (EXC AERIAL)	2890mm/9'5"	
MTPLM	3650kg	4400kg
MAX USER PAYLOAD	519kg (Manual)	1269kg (Auto)

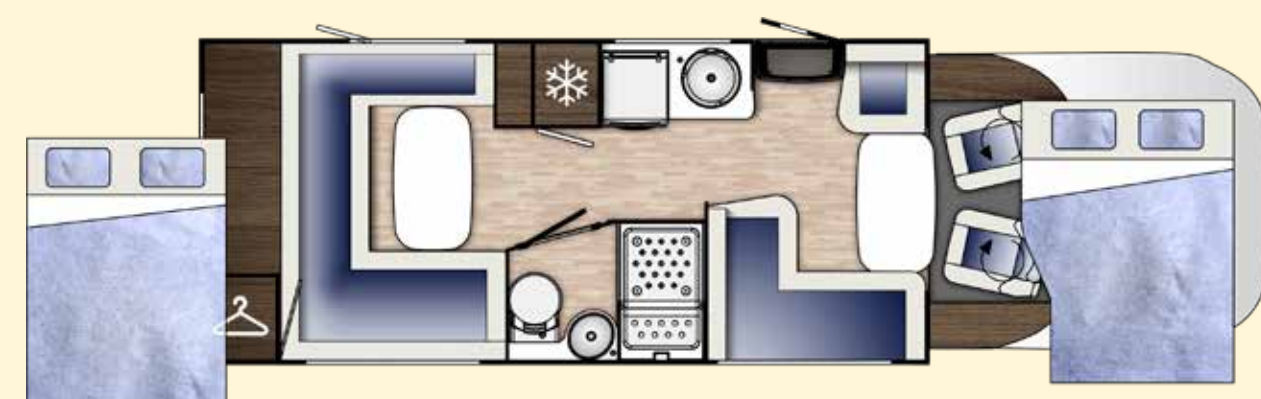

Mileo 282



OVERALL LENGTH	7390mm/24'2"	
OVERALL WIDTH (MIRRORS FOLDED)	2300mm/7'6"	
OVERALL HEIGHT (EXC AERIAL)	2890mm/9'5"	
MTPLM	3650kg	4400kg
MAX USER PAYLOAD	434kg (Manual)	1184kg (Auto)



Mileo 294



OVERALL LENGTH	7350mm/24'1"	
OVERALL WIDTH (MIRRORS FOLDED)	2300mm/7'6"	
OVERALL HEIGHT (EXC AERIAL)	2890mm/9'5"	
MTPLM	3650kg	4400kg
MAX USER PAYLOAD	526kg (Manual)	1172kg (Auto)



Mileo Key Features & Benefits



CHOOSE FROM A 3650KG FIAT 140BHP MANUAL OR 4400KG 180BHP AUTOMATIC CHASSIS

Ensuring a comfortable driving experience with an electronic parking brake.



GPS TRACKSTAR TRACKER WITH FREE ONE YEAR SUBSCRIPTION

Your new Mileo motorhome is protected 24/7 with the Trafficmaster Trackstar S7 Tracker with a free 1 year subscription included.



TOUCH SCREEN DAB RADIO, SAT NAV & INTEGRATED REAR VIEW OBSERVATION CAMERA

Make your way to your holiday destination with ease & with the latest audio technology.



EXTERIOR BBQ & SHOWER POINTS

From washing off a muddy dog to grilling an el fresco dinner, this couldn't be easier thanks to the functionality of the external BBQ & shower points.



NCC APPROVED WITH FULL UK SPECIFICATION.

Your Mileomotorhome has been rigorously tested to meet all NCC approval standards to be certified safe for you & your family as well as being legal for use on UK roads.



SPACE-SAVING ELECTRIC DROP DOWN DOUBLE BED OPTIONS

Benimar have expertly designed the Mileo range to include a number of versatile & space saving bed options. Both comfortable & spacious, there are many bed configurations across 4 layouts to choose from.



CAB AIR-CONDITIONING, CRUISE CONTROL WITH ABS, ESP, TRACTION CONTROL & HILL ASSIST

Drive with ultimate comfort thanks to the inclusion of the latest driver assistance technology on either a manual or automatic.



SECURE HABITATION DOOR WITH REMOTE CENTRAL LOCKING

For additional security all Mileo motorhomes feature habitation doors with remote central locking systems with window and flyscreens.

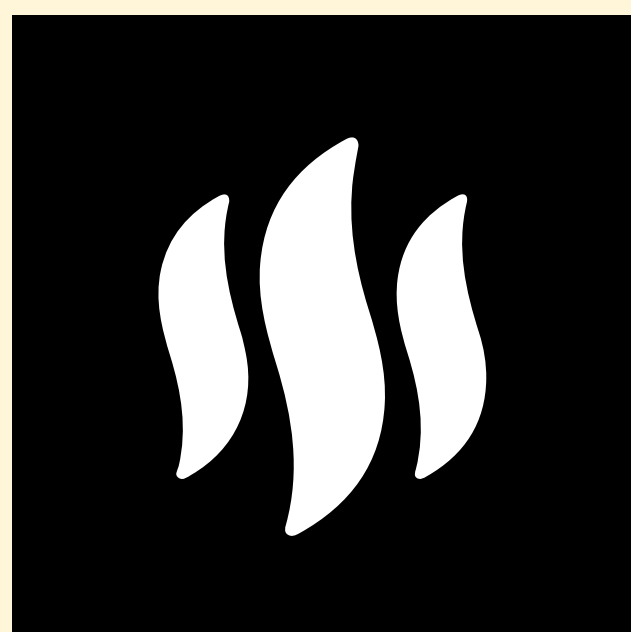

ELECTRIC & HEATED WING MIRRORS

Mileo door mirrors are electrically heated, eliminating ice & condensation build-up quickly, to help you see more clearly in any weather.

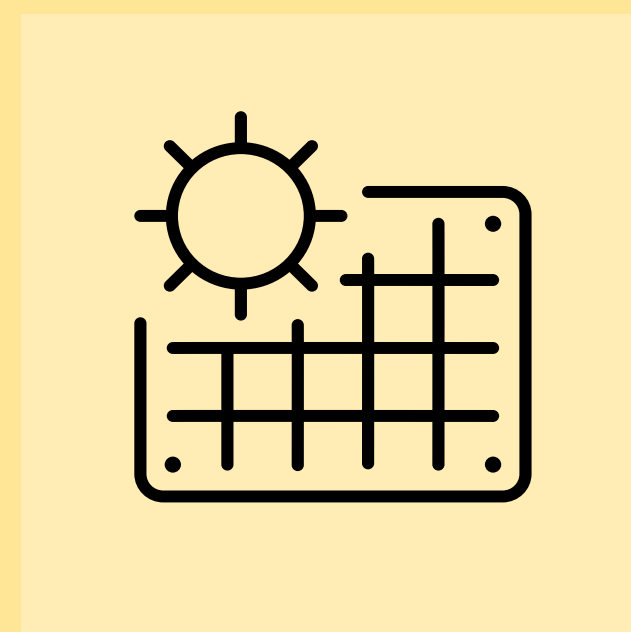

SOLAR PANEL

The Solar Panel can ensure your batter life lasts longer. Being self-sufficient helps you enjoy the freedom a motorhome brings.



GRADE III FULLY INSULATED NCC EN1645-1

Enjoy the perfect climate 365 days a year. All Mileo motorhomes have achieved Grade III classification for heating & thermal protection.

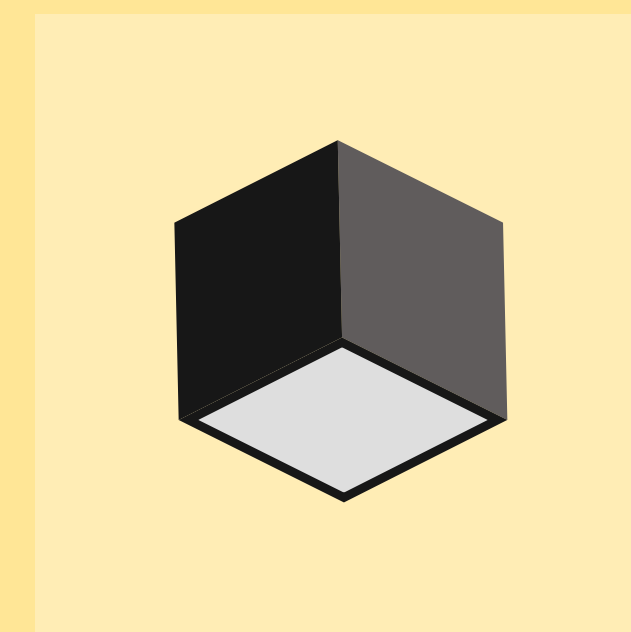

GRP & 99% WOOD FREE CONSTRUCTION

Benimar motorhomes offer the almost complete elimination of wood in the bodywork structure. The use of damp-proof materials, which are effective at insulating, guarantee the vehicle lasts longer.

Mileo Features

CHASSIS

- Choice of 140bhp Euro 6D Manual or 180bhp Automatic Engine with AdBlue Technology inc ABS brakes,
- ESP Traction Control & Hill Assist
- 2 year chassis warranty

- 90 litre fuel tank
- Black front grill with chrome stripe
- New Metallic Black Cab

DRIVER COMFORT

- Cab air conditioning
- Automatic climate control
- Cab reading lights
- Adjustable steering wheel
- Fully upholstered & heated swivel captain chairs with two arm rests & height adjustment
- Door pockets & bottle holders
- 12v lighter sockets & USB port
- Aluminium dashboard kit
- Rear corner steadies

- Concertina blinds on doors & windscreen
- Gear stick & steering wheel in leather finish
- Removable carpets including entrance mat
- Heated driver and passenger cab seats
- High resilience seat foam & backrests (130mm/5")
- 2 double USB sockets located behind driver's seat

DRIVER SAFETY

- NCC approval & full UK specification
- Driver & passenger air bags
- Cruise control
- ABS, ESP, Traction control, hill assist & curve assist
- Rear axle width of 1980mm for improved stability
- Remote central locking of cab doors & immobiliser
- LED daytime running lights
- Alloy wheels plus full spare on all

- models
- Electric cab windows
- Heated & electric wing mirrors
- Automatic headlights & windscreen wipers
- Security pack
- Colour coded front bumper
- Rear bumper with LED lights
- New rear bumper with multifunctional lights
- Electric handbrake

AUDIO SYSTEM

- Media function controls on steering wheel
- MP3 player, USB connection & Bluetooth handsfree
- On/off isolator switch for radio

- High level DAB radio with touch screen sat nav & integrated rear view observation camera
- Rear speakers
- Wireless charging

BODY CONSTRUCTION

- Remote locking habitation door on UK side with window & flyscreen
- LED awning light
- External shower point
- External BBQ point
- GRP & 99% wood free construction
- 25mm XPS insulation on sidewalls
- 53mm XPS insulation on floor & roof
- High impact, scratch resistant flooring
- 120 litre fresh water tank isolated & heated with level sensor
- 105 litre waste water tank isolated & heated with level sensor
- Three point seat belts to all designated passenger seats
- High & low fixing points for optional rear mounted cycle rack

- Spacious rear garage with ample storage for leisure equipment with lighting (selected models)
- ABS lower moulded rear panel with integral lights
- High level brake light
- Colour coded side skirts
- High quality double glazed opening windows with night-latch ventilation
- Flyscreens & blinds on all windows
- Gas bottle compartment
- Gas regulator suitable for butane or propane
- New exterior design

LIVING AREA

- Truma iNet X control panel
- Entrance light
- Dometic Deluxe windows
- Marel ash & nacre style combination furniture
- Rooflights
- Space-saving electric dropdown beds with removable aluminium ladder (selected models)

- Secure positive catches on all furniture doors with soft closing hinges
- Skyview rooflight
- Multi directional sliding table (selected models)
- TV bracket
- New Cambridge upholstery design with optional Newport

WASHROOM

- Thetford cassette toilet with electric flush & 18 litre wheeled holding tank
- Chrome finish brass mixer taps & shower head
- Rooflight with flyscreen
- Towel holder

- Washbasin with single door cupboard below
- Fully separate shower
- Bathroom accessories

KITCHEN

- Extractor hood
- Decorative kitchen lights
- Metal drawer runners with soft closing system
- Dual fuel gas & electric hob with glass lid with oven & grill
- Stainless steel sink with glass lid
- Microwave oven

- 145 litre fridge/freezer with automatic energy selection (excl 286)
- 135 litre fridge/freezer (286)
- Grey stone kitchen work top
- Microwave oven
- Work top extension
- Illuminated spice rack

ELECTRICS, GAS & PLUMBING

- 3 x 220v sockets
- 3 x 12v sockets
- TV aerial
- Mains consumer unit with mains isolator
- 12v fuse board with battery recharger
- Large & easy to read 12v control panel near to the entrance door
- Low energy consumption LED lighting
- Truma combi 6kw heating & water system which operates on gas or electric

- Pressurized fresh water system with self-filling pump
- Isolation taps for gas appliances
- Solar panel
- Fan rooflight
- Grade III Winter pack incl:
 - Insulated & heated waste tanks
 - Insulated external pipes
 - External thermal screen cover
 - External fridge vent covers
- CO2 alarm
- Smoke alarm

SECURITY SYSTEMS

- Trafficmaster Trackstar S7 Tracker with 1 years free subscription

- Manufacturer Immobiliser

WARRANTY



For full warranty details please visit:
www.marquisleisure.co.uk/warranty

WEIGHTS & DIMENSIONS

MILEO RANGE

Model	MILEO 243		MILEO 282		MILEO 286		MILEO 294	
	140bhp Manual	180bhp Automatic	140bhp Manual	180bhp Automatic	140bhp Manual	180bhp Automatic	140bhp Manual	180bhp Automatic
Berths (sleeping positions)	4		4		4		4	
Designated Passenger Seats (incl. driver)	4		4		4		4	
Overall Length	6990mm / 22'11"		7390mm / 24'2"		6950mm / 22'8"		7350mm / 24'1"	
Overall Width (mirrors folded)	2330mm / 7'6"		2330mm / 7'6"		2330mm / 7'6"		2330mm / 7'6"	
Overall Width (mirrors extended)	2750mm / 9'0"		2750mm / 9'0"		2750mm / 9'0"		2750mm / 9'0"	
Overall Height (excl. TV aerial)	2890mm / 9'5"		2890mm / 9'5"		2890mm / 9'5"		2890mm / 9'5"	
Internal Height (max)	2110mm / 6'9"		2110mm / 6'9"		2110mm / 6'9"		2110mm / 6'9"	
Maximum Permissible Laden Mass (a)	3650kg	4400kg	3650kg	4400kg	3650kg	4400kg	3650kg	4400kg
Mass in Running Order (b)	3149kg		3200kg		3250kg		3240kg	
Maximum User Payload (c) (c=a-b)	501kg	1251kg	434kg	1184kg	519kg	1269kg	526kg	1172kg
Maximum Trailer Weight	1750kg		2000kg		2000kg		2000kg	
Gross Train Weight	5400kg	6150kg	5400kg	6150kg	5400kg	6150kg	5400kg	6150kg
Bed Sizes								
Drop Down Bed	1400mm x 1900mm 4'6" x 6'2"		1400mm x 1900mm 4'6" x 6'2"		1400mm x 1900mm 4'6" x 6'2"		1400mm x 1900mm 4'6" x 6'2"	
Front Double	-		1400mm x 1900mm 4'6" x 6'2"		1300mm x 2100mm 4'3" x 6'9"		-	
Rear Double	1390mm x 2000mm 4'6" x 6'6"		-		-		1390mm x 1900mm 4'6" x 6'2"	
Rear Garage Dimensions								
Rear Garage Aperture Dimensions#	945/1215mm (h) x 1410mm (w) x 2175mm (d)		1510mm (h) x 510mm (w) x 1510mm (d)		1190mm (h) x 805mm (w) x 2175mm (d)		760/1030mm (h) x 1380/800mm (w) x 2175mm (d)	
Rear Garage Max Load Limit	225kg		225kg		225kg		225kg	

Data & accuracy: The contents of this publication are as accurate as possible at the time of going to press, but this information should not be regarded as an infallible guide to current specifications, nor does it constitute an offer for the sale of any particular vehicle. Details of performance, dimensions and weights are subject to minor deviations within manufacturer tolerance limits (max +/- 5%). The Mass In Running Order (MIRO) - Weight of the Motorhome equipped to the manufacturer's standard specification including essential habitational equipment. The MIRO is the mass of the unladen vehicle, including an allowance for the driver (assumed 75 kg) and a 90% full fuel tank. The MIRO is calculated with the fresh water tank empty. If you travel with water in the freshwater tank then the User Payload will reduce accordingly. Maximum User Payload includes Personal Effects Payload, conventional load and the Optional Equipment Payload. Please ensure that you've allowed for the masses of all items you intend to carry in the Motorhome. All data is calculated using metric weights and measurements. The imperial figures quoted are conversions thereof and have been rounded to the nearest inch. All dimensions have a tolerance of +/- 25mm. Your Motorhome weights have been calculated with all water tanks empty and we recommend you travel with all water tanks empty. Heights are measured on an unladen vehicle excluding any roof areal. The maximum weight capacity for an electric drop down bed is 250kg, fixed rear beds have a limit of 250kg, overcab beds are 250kg and bunkbeds 100kg. # Garage dimensions quoted are "aperture" height and width and interior garage dimensions may vary.



OVERVIEW

MILEO RANGE

FEATURES

WEIGHTS & DIMENSIONS

360°
VIRTUAL TOURS

▶
VIDEO REVIEWS

